

Assembly Drawing

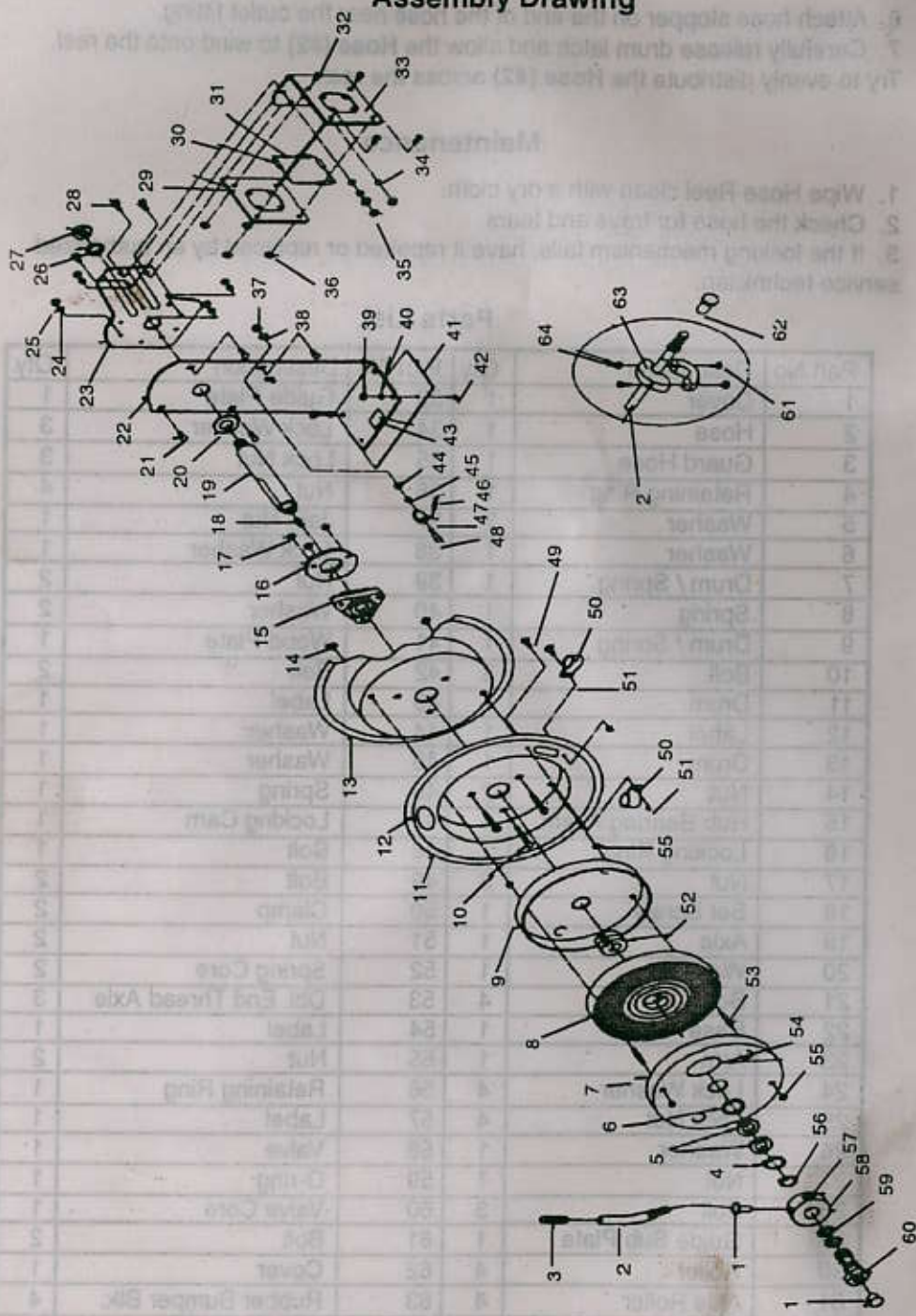

CENTRAL PNEUMATIC®

AUTO REWIND HOSE REEL WITH HOSE

Model 46104

ASSEMBLY AND OPERATING INSTRUCTIONS

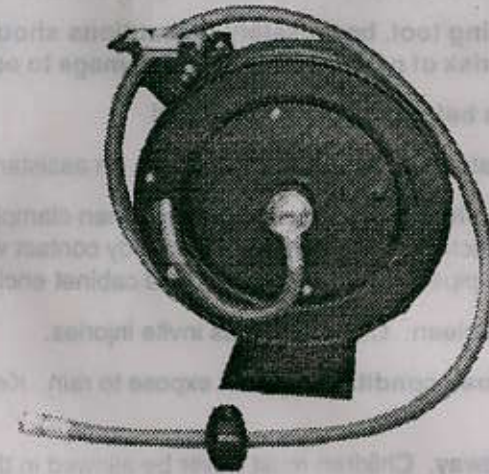

Distributed Exclusively by



HARBOR FREIGHT TOOLS



3491 Mission Oaks Blvd., Camarillo, CA 93011

Visit our Web site at <http://www.harborfreight.com>

Copyright © 2001 by Harbor Freight Tools. All rights reserved. No portion of this manual or any artwork contained herein may be reproduced in any shape or form without the express written consent of Harbor Freight Tools.

For technical questions and replacement parts, please call 1-800-444-3353

Specifications

Working Pressure Capacity	250 PSI
Dimensions	6-1/4" W x 13-1/8" L x 15" H
Bracket Dimensions	5-1/16" W x 5-11/16" L
Hose	25 Feet x 3/8" NPT Rubber / Threaded

Save This Manual

You will need the manual for the safety warnings and precautions, assembly instructions, operating and maintenance procedures, parts list and diagram. Keep your invoice with this manual. Write the invoice number on the inside of the front cover. Keep the manual and invoice in a safe and dry place for future reference.

Safety Warnings and Precautions

WARNING: When using tool, basic safety precautions should always be followed to reduce the risk of personal injury and damage to equipment.

Read all instructions before using this product!

- Avoid working alone.** If an accident happens, an assistant can bring help.
- Avoid electrical shock.** Use extreme caution when clamping around uninsulated conductors or bus bars. Prevent body contact with grounded surfaces such as pipes, radiators, ranges, and cabinet enclosures.
- Keep work area clean.** Cluttered areas invite injuries.
- Observe work area conditions.** Don't expose to rain. Keep work area well lighted.
- Keep children away.** Children must never be allowed in the work area. Do not let them handle machines, tools, extension cords, or air hoses.
- Store idle equipment.** When not in use, tools must be stored in a dry location to inhibit rust. Always lock up tools and keep out of reach of children.
- Dress properly.** Do not wear loose clothing or jewelry as they can be caught in moving parts. Protective, electrically nonconductive clothes and nonskid footwear are recommended when working. Wear restrictive hair covering to contain long hair.
- Use eye and ear protection.** Always wear ANSI approved impact safety goggles.

- Attach hose stopper on the end of the hose near the outlet fitting.
- Carefully release drum latch and allow the **Hose (#2)** to wind onto the reel. Try to evenly distribute the **Hose (#2)** across the reel.

Maintenance

- Wipe Hose Reel clean with a dry cloth.
- Check the hose for frays and tears.
- If the locking mechanism fails, have it repaired or replaced by an authorized service technician.

Parts List

Part No.	Description	Qty.	Part No.	Description	Qty.
1	Cover	1	33	Guide Plate	1
2	Hose	1	34	Lock Washer	3
3	Guard Hose	1	35	Lock Nut	3
4	Retaining Ring	1	36	Nut	4
5	Washer	2	37	Jam Nut	1
6	Washer	1	38	Lock Washer	1
7	Drum / Spring	1	39	Nut	2
8	Spring	1	40	Washer	2
9	Drum / Spring	1	41	Wood Plate	1
10	Bolt	3	42	Bolt	2
11	Drum	1	43	Label	1
12	Label	1	44	Washer	1
13	Drum	1	45	Washer	1
14	Nut	2	46	Spring	1
15	Hub Bearing Assm.	1	47	Locking Cam	1
16	Locking Ring	1	48	Bolt	1
17	Nut	3	49	Bolt	2
18	Set Screw	1	50	Clamp	2
19	Axle	1	51	Nut	2
20	Washer	1	52	Spring Core	2
21	Bolt	4	53	Dbi. End Thread Axle	3
22	Base	1	54	Label	1
23	Arm	1	55	Nut	2
24	Lock Washer	4	56	Retaining Ring	1
25	Lock Nut	4	57	Label	1
26	Washer	1	58	Valve	1
27	Nut	1	59	O-ring	1
28	Bolt	3	60	Valve Core	1
29	Guide Sub Plate	1	61	Bolt	2
30	Roller	4	62	Cover	1
31	Axle Roller	4	63	Rubber Bumper Blk.	4
32	Bolt	4	64	Nut	2

Unpacking

When unpacking, check to make sure the parts listed on page 8 are included. If any parts are missing or broken, please call Harbor Freight Tools at the number on the cover of this manual.

Installation of Reel

(Mounting hardware not included)

The template below is not to scale. Make a template of your own modeling this one, using the measurements listed inside.

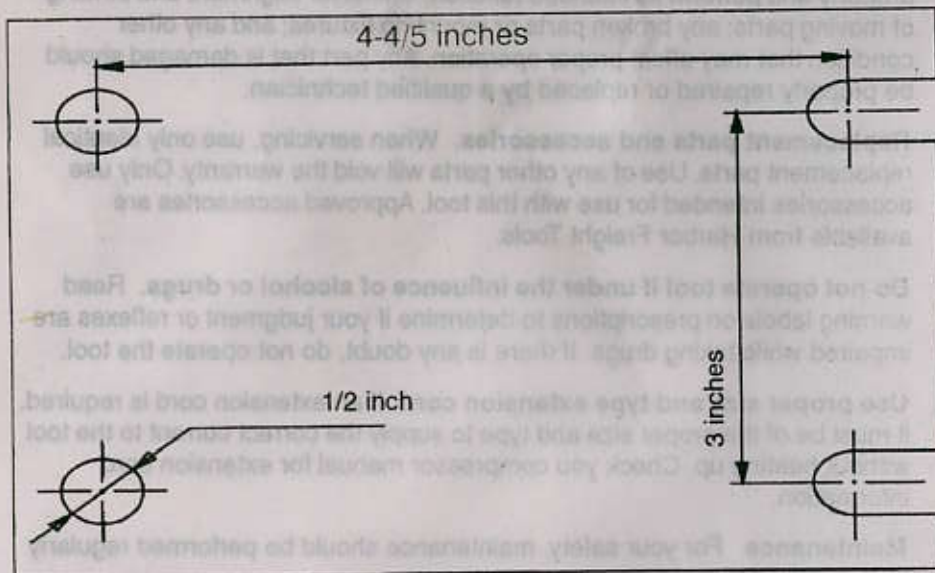

1. Make a paper template modeled after the one above.
2. The Reel may be installed on the wall, floor, or ceiling (at least ten feet above the floor).
3. Remove the bolts that attach the guide roller bracket to the support post to re-position the bracket for the appropriate location. Replace bolts and tighten.
4. Drill holes to accommodate 1/2 inch bolts (not included). Make sure you are drilling into a solid backing, or use the appropriate hardware to anchor in the bolts.
5. Mount reel and secure the four bolts (not included) through the 1/2" holes in the bracket. See Figure 1 on page 5.

Figure 1

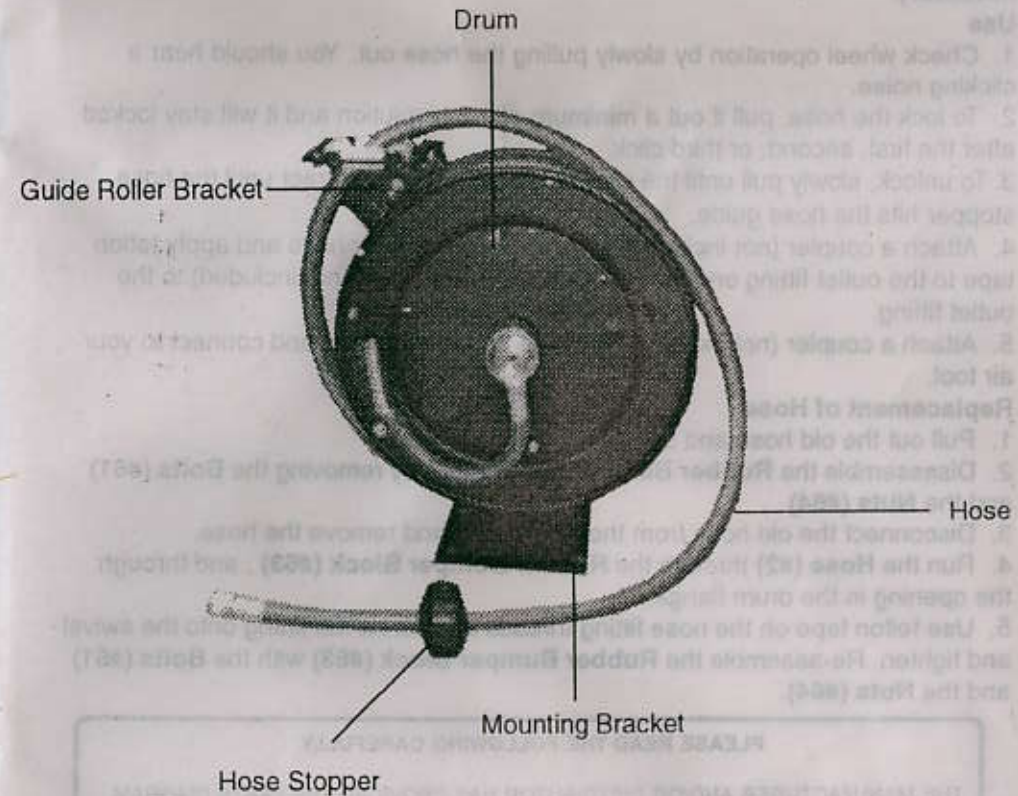

PLEASE READ CAREFULLY
THE MANUFACTURER AND/OR DISTRIBUTOR HAS PROVIDED THIS MANUAL AS A REFERENCE TOOL ONLY. THE MANUFACTURER
HOWEVER, THE MANUFACTURER MAKES NO WARRANTY OR REPRESENTATION OF ANY KIND FOR
THE SYSTEM THAT HE OR SHE IS QUALIFIED TO MAKE ANY REPAIR TO THE
PRODUCT OR THAT HE OR SHE IS QUALIFIED TO REPLACE ANY PARTS OF THE
PRODUCT. IN FACT, THE MANUFACTURER AND/OR DISTRIBUTOR SHOULD BE ADVISED
THAT ALL REPAIRS AND PARTS REPLACEMENTS SHOULD BE INSTALLED
BY CERTIFIED AND LICENSED TECHNICIANS AND NOT BY THE BUYER. THE BUYER
ASSUMES ALL RISK AND LIABILITY ARISING OUT OF HIS OR HER REPAIR TO THE
ORIGINAL PRODUCT OR REPLACEMENT PARTS THEREON OR ARISING OUT OF HIS
OR HER INSTALLATION OR REPLACEMENT PARTS THEREON.

NOTE: Some parts are listed and shown for illustrative purposes only and are not
necessarily included as replacement parts.

Operation

See Figure 1

Adjustment of Spring Tension

1. Pull out six feet of hose.
2. Remove the hose stopper from the hose and feed it back through the guide.
3. To increase tension, wrap the pulled hose one time around the drum.
4. To decrease tension, un-wrap the hose one time from the drum.
5. Run the hose back through the guide and re-attach the hose stopper.
6. Unlatch the hose and check the tension. Adjust the stopper position if necessary.

Use

1. Check wheel operation by slowly pulling the hose out. You should hear a clicking noise.
2. To lock the hose, pull it out a minimum of 1/2 revolution and it will stay locked after the first, second, or third click.
3. To unlock, slowly pull until the clicking stops, and let it retract until the hose stopper hits the hose guide.
4. Attach a coupler (not included) to your air compressor hose and apply teflon tape to the outlet fitting on the reel. Connect the coupler (not included) to the outlet fitting.
5. Attach a coupler (not included) onto the end of the hose, and connect to your air tool.

Replacement of Hose

1. Pull out the old hose and securely lock Hose Reel.
2. Disassemble the **Rubber Bumper Block (#63)** by removing the **Bolts (#61)** and the **Nuts (#64)**.
3. Disconnect the old hose from the swivel joint and remove the hose.
4. Run the **Hose (#2)** through the **Rubber Bumper Block (#63)**, and through the opening in the drum flange.
5. Use teflon tape on the hose fitting threads and screw the fitting onto the swivel and tighten. Re-assemble the **Rubber Bumper Block (#63)** with the **Bolts (#61)** and the **Nuts (#64)**.

PLEASE READ THE FOLLOWING CAREFULLY

THE MANUFACTURER AND/OR DISTRIBUTOR HAS PROVIDED THE PARTS DIAGRAM IN THIS MANUAL AS A REFERENCE TOOL ONLY. NEITHER THE MANUFACTURER NOR DISTRIBUTOR MAKES ANY REPRESENTATION OR WARRANTY OF ANY KIND TO THE BUYER THAT HE OR SHE IS QUALIFIED TO MAKE ANY REPAIRS TO THE PRODUCT OR THAT HE OR SHE IS QUALIFIED TO REPLACE ANY PARTS OF THE PRODUCT. IN FACT, THE MANUFACTURER AND/OR DISTRIBUTOR EXPRESSLY STATES THAT ALL REPAIRS AND PARTS REPLACEMENTS SHOULD BE UNDERTAKEN BY CERTIFIED AND LICENSED TECHNICIANS AND NOT BY THE BUYER. THE BUYER ASSUMES ALL RISK AND LIABILITY ARISING OUT OF HIS OR HER REPAIRS TO THE ORIGINAL PRODUCT OR REPLACEMENT PARTS THERETO, OR ARISING OUT OF HIS OR HER INSTALLATION OF REPLACEMENT PARTS THERETO.

NOTE: Some parts are listed and shown for illustration purposes only and are not available individually as replacement parts.

9. **Do not overreach.** Keep proper footing and balance at all times. Do not reach over or across air hoses.
10. **Maintain tools with care.** Inspect hose periodically and, if damaged, have it repaired by an authorized technician.
11. **Use the right tool for the job.** Do not attempt to force a small tool or attachment to do the work of a larger industrial tool. There are certain applications for which this tool was designed. Do not modify this tool and do not use this tool for a purpose for which it was not intended.
12. **Stay alert.** Watch what you are doing, use common sense. Do not operate any tool when you are tired.
13. **Check for damaged parts.** Before using any tool, any part that appears damaged should be carefully checked to determine that it will operate properly and perform its intended function. Check for alignment and binding of moving parts; any broken parts or mounting fixtures; and any other condition that may affect proper operation. Any part that is damaged should be properly repaired or replaced by a qualified technician.
14. **Replacement parts and accessories.** When servicing, use only identical replacement parts. Use of any other parts will void the warranty. Only use accessories intended for use with this tool. Approved accessories are available from Harbor Freight Tools.
15. **Do not operate tool if under the influence of alcohol or drugs.** Read warning labels on prescriptions to determine if your judgment or reflexes are impaired while taking drugs. If there is any doubt, do not operate the tool.
16. **Use proper size and type extension cord.** If an extension cord is required, it must be of the proper size and type to supply the correct current to the tool without heating up. Check you compressor manual for extension cord information.
17. **Maintenance.** For your safety, maintenance should be performed regularly by a qualified technician.

Warning: The warnings, cautions, and instructions discussed in this instruction manual cannot cover all possible conditions and situations that may occur. It must be understood by the operator that common sense and caution are factors which cannot be built into this product, but must be supplied by the operator.

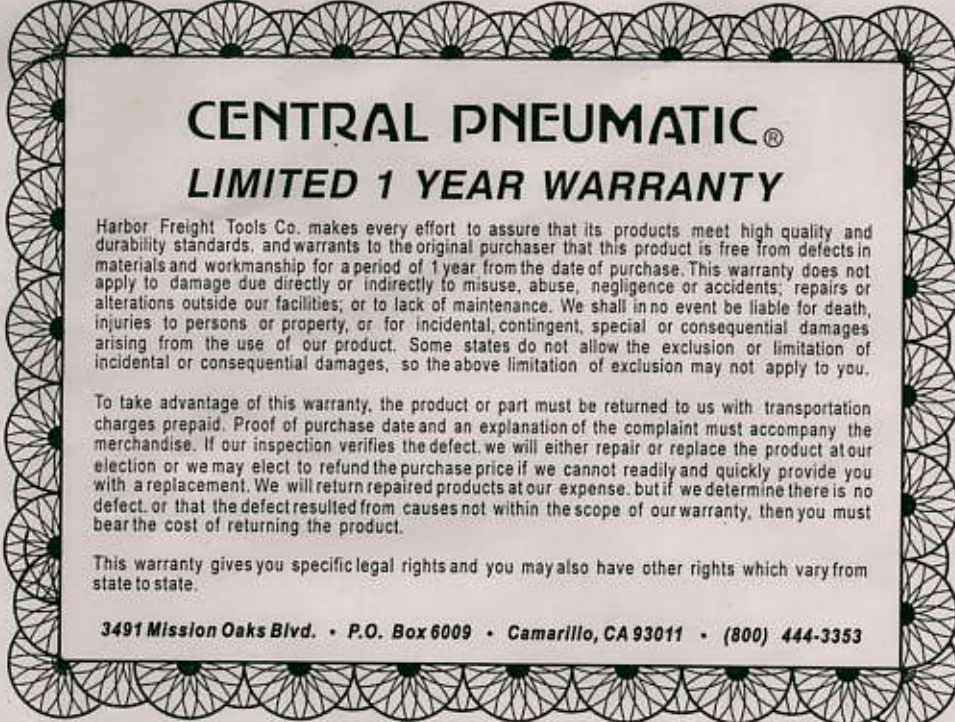

CENTRAL PNEUMATIC®

LIMITED 1 YEAR WARRANTY

Harbor Freight Tools Co. makes every effort to assure that its products meet high quality and durability standards, and warrants to the original purchaser that this product is free from defects in materials and workmanship for a period of 1 year from the date of purchase. This warranty does not apply to damage due directly or indirectly to misuse, abuse, negligence or accidents; repairs or alterations outside our facilities; or to lack of maintenance. We shall in no event be liable for death, injuries to persons or property, or for incidental, contingent, special or consequential damages arising from the use of our product. Some states do not allow the exclusion or limitation of incidental or consequential damages, so the above limitation of exclusion may not apply to you.

To take advantage of this warranty, the product or part must be returned to us with transportation charges prepaid. Proof of purchase date and an explanation of the complaint must accompany the merchandise. If our inspection verifies the defect, we will either repair or replace the product at our election or we may elect to refund the purchase price if we cannot readily and quickly provide you with a replacement. We will return repaired products at our expense, but if we determine there is no defect, or that the defect resulted from causes not within the scope of our warranty, then you must bear the cost of returning the product.

This warranty gives you specific legal rights and you may also have other rights which vary from state to state.

3491 Mission Oaks Blvd. • P.O. Box 6009 • Camarillo, CA 93011 • (800) 444-3353